

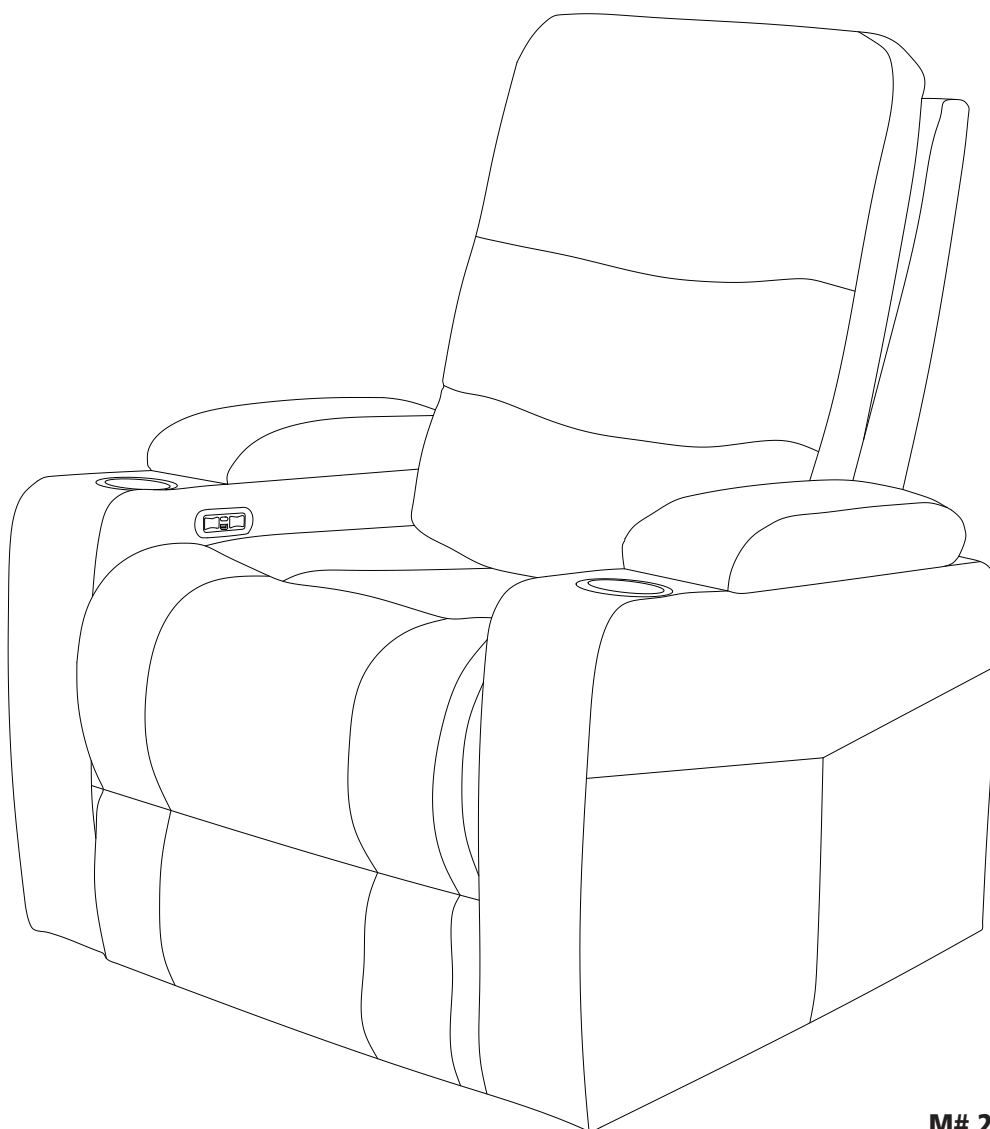

## Serta Home Theater Recliner



**M# 2080-8693-86  
2080-8752-86  
2080-8753-86**

### **Assembly and Care Instructions**

**IMPORTANT, RETAIN FOR FUTURE REFERENCE: READ CAREFULLY.**

THIS CHAIR CAN SUPPORT UP TO:  
CE FAUTEUIL PEUT SUPPORTER JUSQU'À:  
ESTE SILLÓN PUEDE SOPORTAR HASTA:  
**158.8kg/350 lb**  
PER SEAT / PAR PLACE / POR ASIENTO

---

## Important Safety Information

- *Please read all instructions carefully before assembling this furniture.*
- *For your safety, assembly by two or more adults is strongly recommended.*
- *Use only vendor-supplied hardware to assemble this item. Using unauthorized hardware could jeopardize the structural integrity of the item.*
- *Hardware may loosen overtime. Periodically check that all connections are tight.*
- *Customer Assistance (spare/replacement parts): 1-800-318-9669*

---

## Before Assembly

- *Remove all parts and hardware from the box. Place all items on a carpeted or scratch-free work surface, as this will avoid damaging parts during assembly.*
- *The shipping box provides an ideal work surface.*
- *To avoid accidentally discarding small parts or hardware, do not dispose of any packaging or contents of the shipping carton until assembly is complete.*
- *Use the parts and hardware lists below to identify and separate each of the pieces included.*
- *The use of power tools for assembly is not recommended. Power tools can damage the hardware and/or split the wood.*

---

## Care and Cleaning

- *Dust often and use a vacuum cleaner crevice tool to clean seams. To maintain the appearance, gently clean soiled areas with a soft cloth dampened with a mild, water based detergent. Remove all lather and wipe with a clean damp cloth. Dry with another soft cloth by blotting the damp surface (do not rub).*
  - *Do not place furniture in direct sunlight and keep furniture at least 60 cm / 2 ft from heat sources to avoid fading.*
-

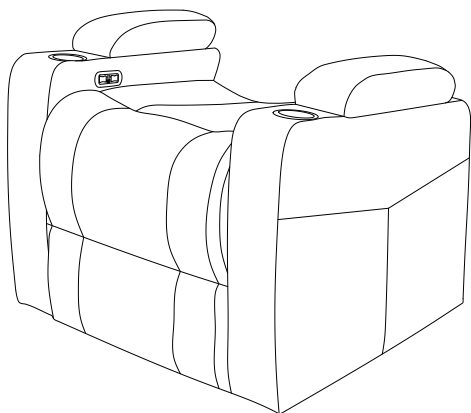

**A**

Seat Base x 1

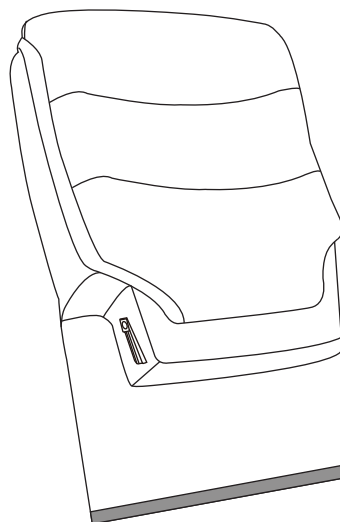

**B**

Back x 1



**C**

power cord x 1

## Attention:

1. Do not stand on the seat cushion.
2. For indoor use only.
3. Please do not expose to direct sunlight.
4. Please do not place this product near sources of excessive heat.
5. Please avoid use of sharp objects on or near this product.
6. Use Fabric Cleaner on spills and marks, as general household cleaners can damage fibers and discolor fabrics.
7. Clean spills / marks immediately, as stains are harder to remove when they are left unattended.
8. For persistent stains and overall cleaning, contact a professional upholstery cleaning company.

# Assembly Instructions

## Step 1

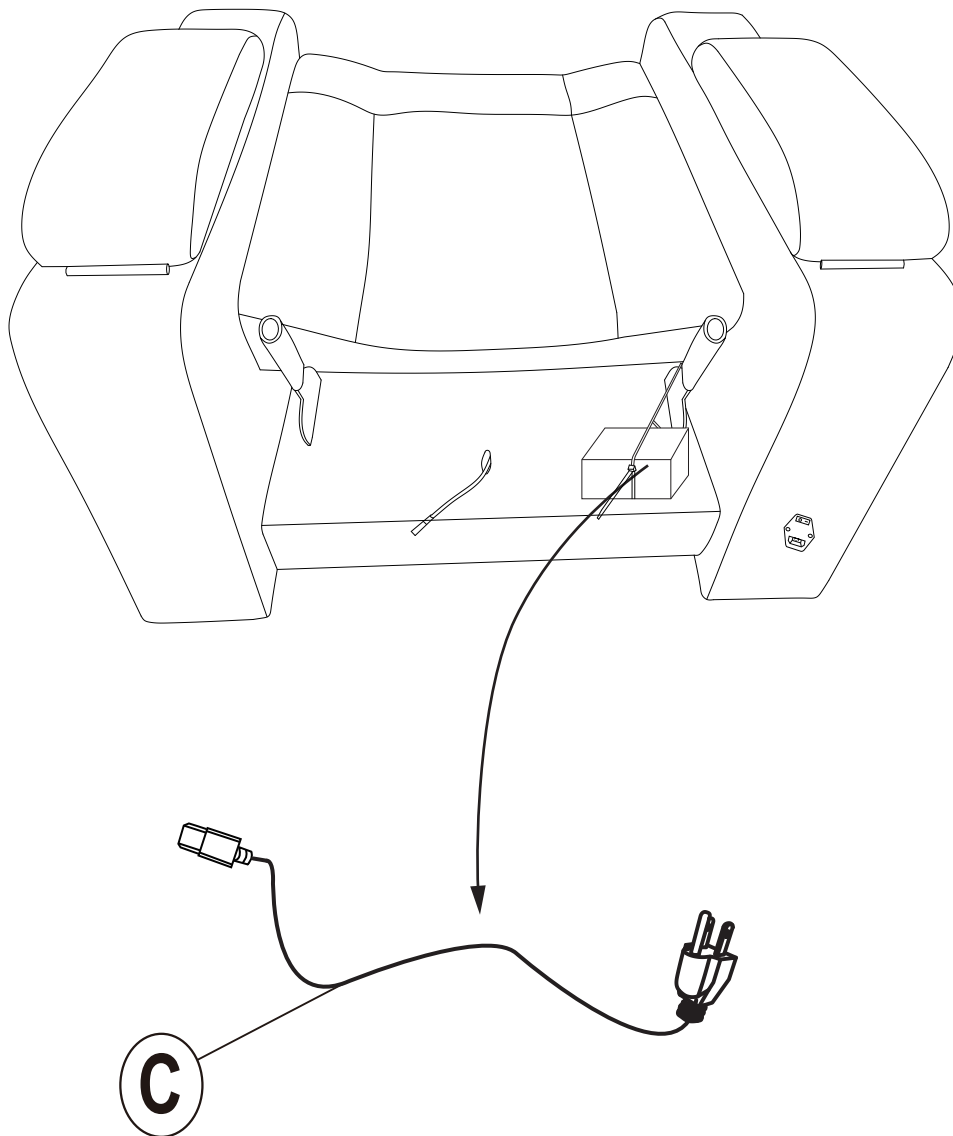

1.

Tack out seat base (A) and back (B) from the carton and tack out power cord carton from back of seat base(A) as shown, then tack out the power cord from the carton. Final, separate all parts into part number groups as indicated in the parts list.

# Assembly Instructions

## Step 2

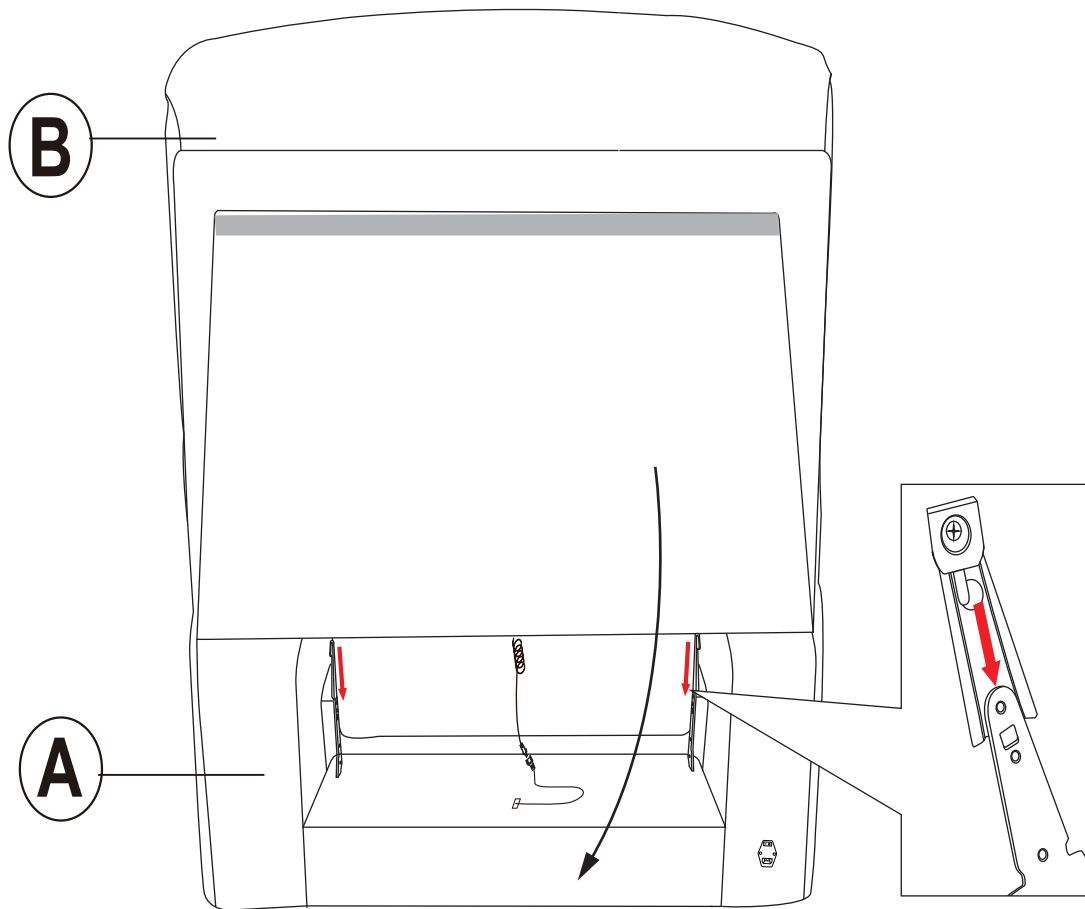

2.

Attach the Back (B) to the Seat base (A) by sliding the receivers into the mechanism posts located on the Seat base (A). From the front of the recliner, press down on both sides of the Back (B) to firmly secure. The Back (B) and Seat base (A) will automatically lock into place. Then pull the back flap down tightly and attach the back flap to the bottom of the Seat base (A).

## Step 3

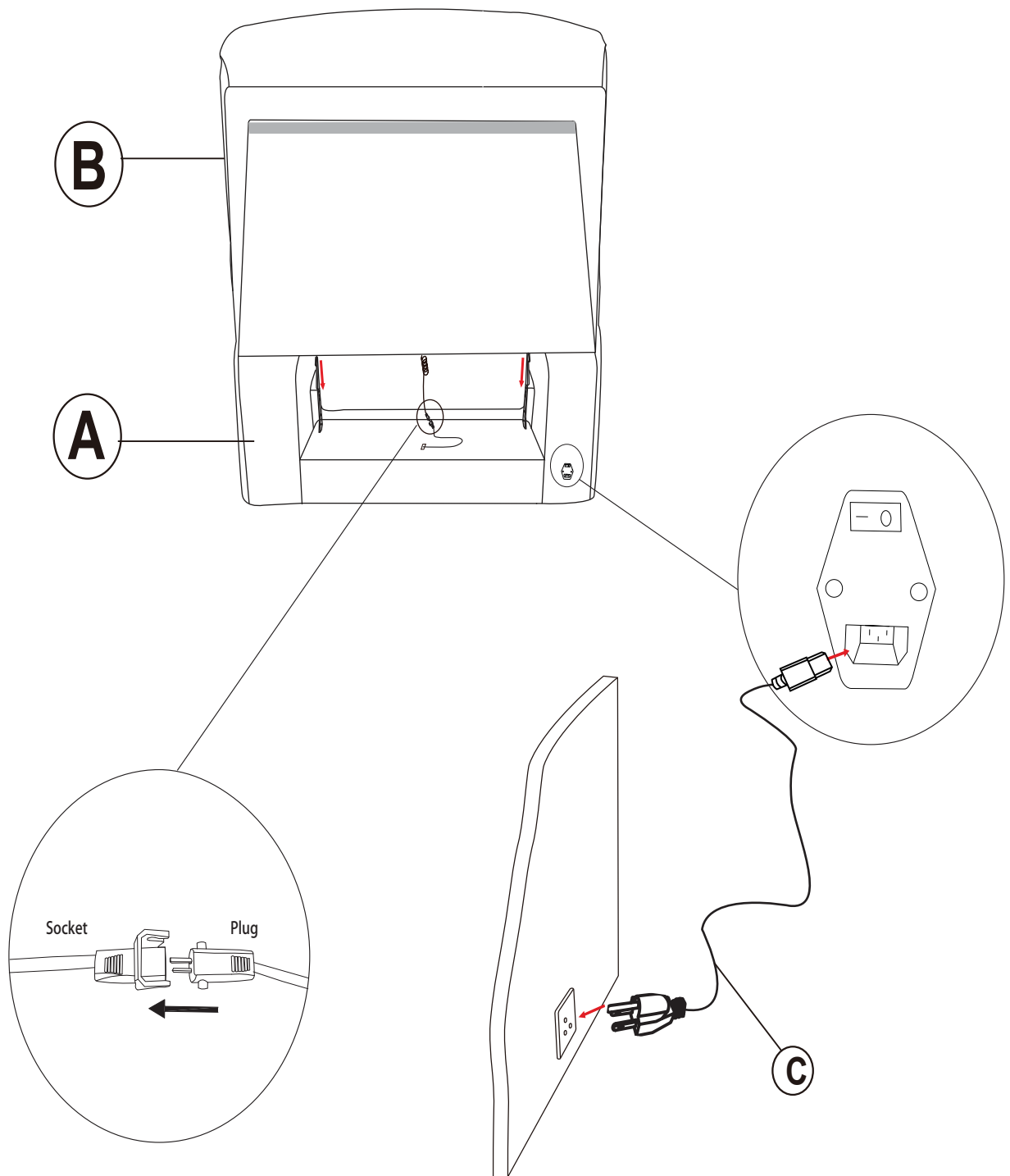

3

First, connect the connector between the back (B) to the bottom of the seat base (A). Then, one end of the power cord (C) is connected to the seat base (A), and the other end is connected to the socket-outlet (110V-240V) after removing the plastic cap from the plug. When the power switch is pressed to the "—", it means it is on, and when it is pressed to the "O", it means it is off. Then pull the back flap down tightly and attach the back flap to the bottom of seat base (A).

NOTE: The socket-outlet shall be installed near the equipment and shall be easily accessible.

# Operating Instructions

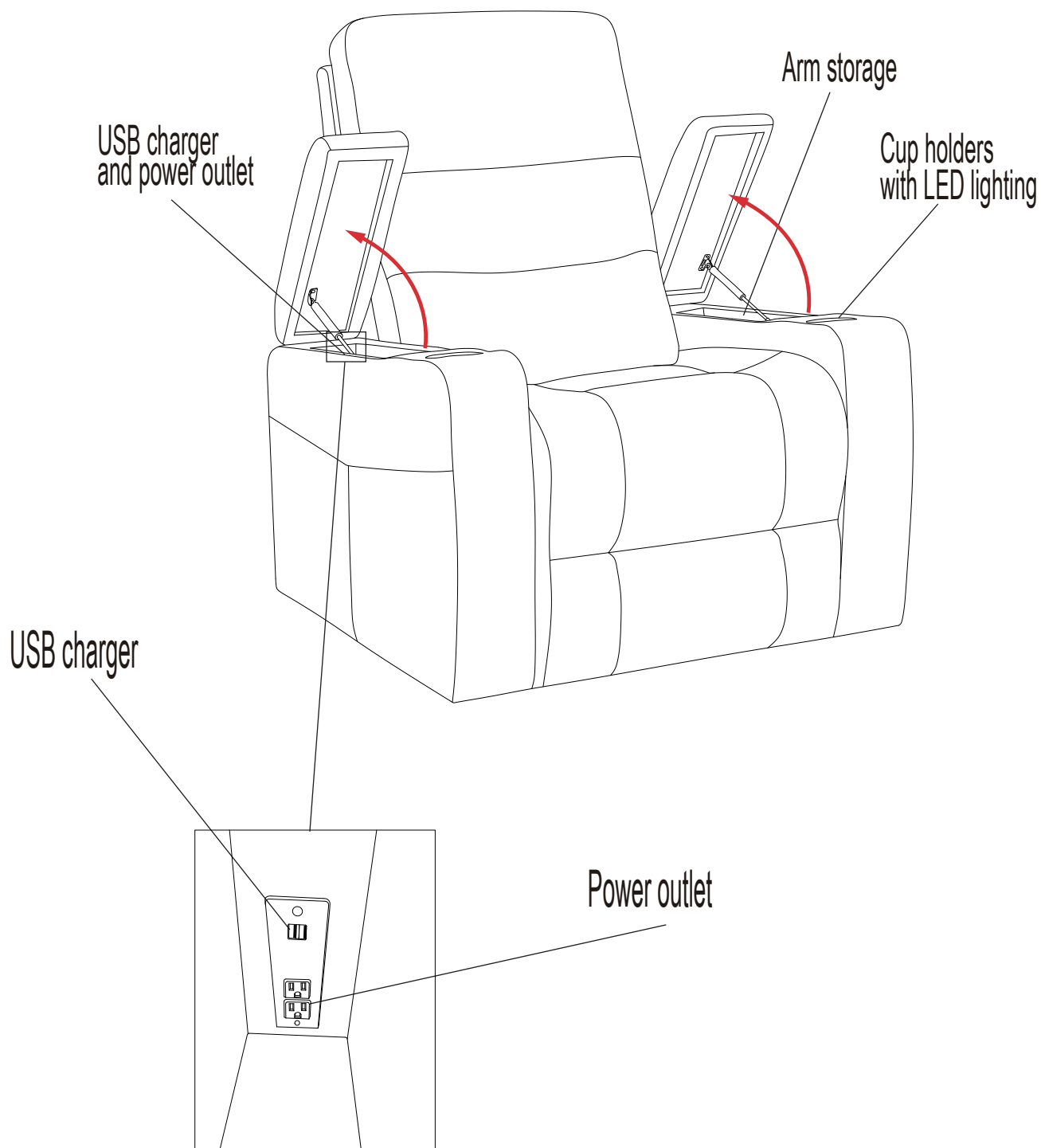

1.

While seated, enjoy the recliner as the shown.

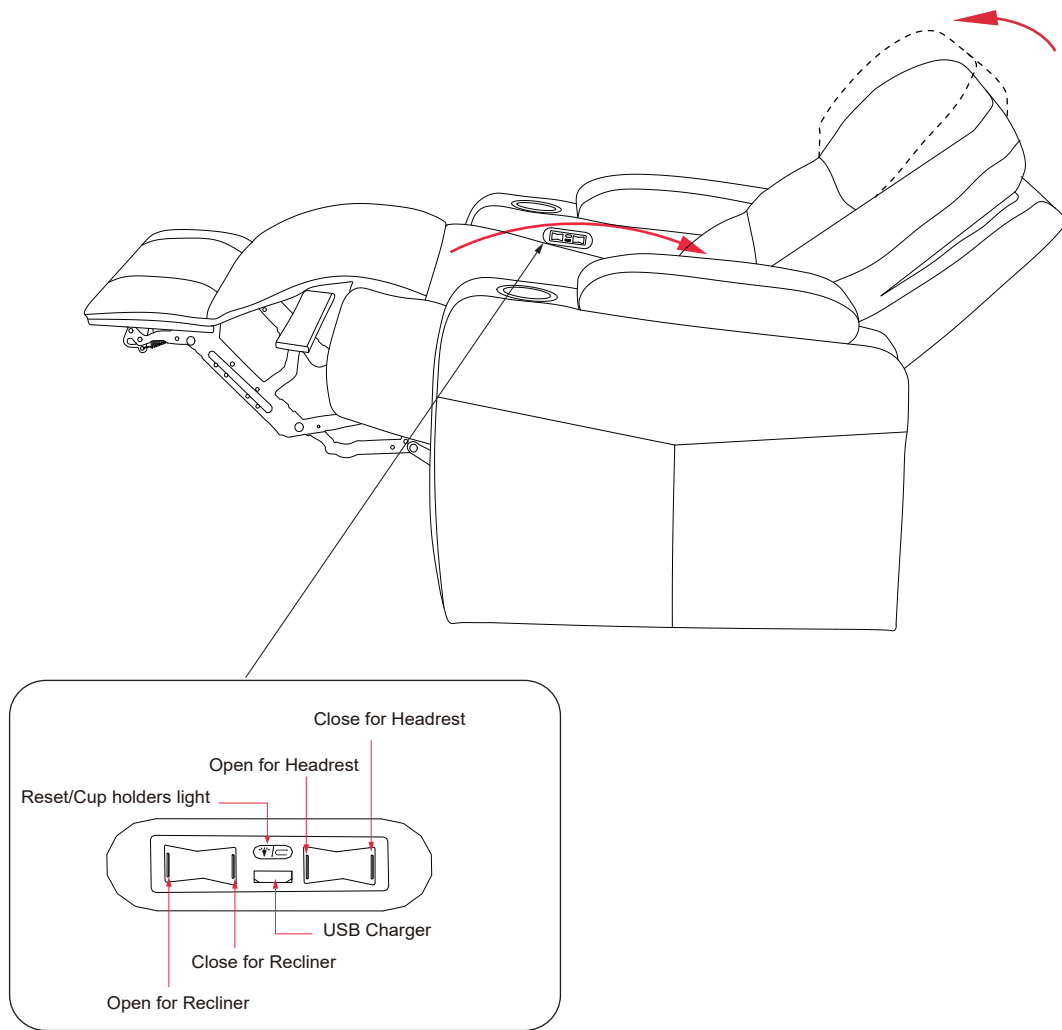

2.

While seated, press the "Cup holders light" control button on the right arm to open the cup holder lights, press the "Open for Recliner" control button on the right arm to make the back cushion recline so it will move backwards. Press the "Open for Headrest" control button on the right arm to adjust headrest. To close the cup holder lights, return the back cushion and pillow to your desired position, press the "Cup holders light", "Close for Recliner" and "Close for Headrest" control button. You can also long press the "Reset" control button to get it back to original position. The electric mechanism can provide you with the most appropriate angle to make you relax. Please remove and put away power cord when it is not in use.

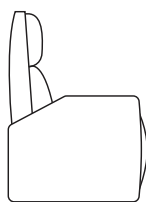

**SIT**

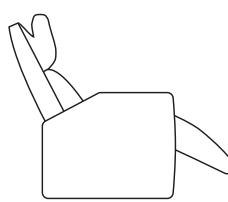

**TV POSITION**

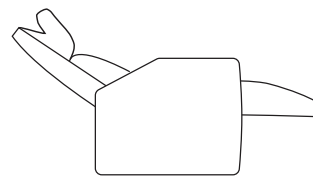

**FULL RECLINE**





### **CAUTION**

1. For your security, please carefully read instructions before charging.
2. The USB charger may not be compatible with all digital electronic devices. The max output voltage is 5V, max current is 2A. Only the digital electronic devices requiring charge within this range may be charged by the USB port.
3. Operation is subject to the following two conditions:
  - (1). This charging device may not cause interference;
  - (2). This charging device must accept any interference, including interference that may cause undesired operation of the device.

Note: This equipment has been tested and found to comply with the limits for a Class B digital device, pursuant to part 15 of the FCC Rules. These limits are designed to provide reasonable protection against harmful interference in a residential installation. This equipment generates, uses and can radiate radio frequency energy and, if not installed and used in accordance with the instructions, may cause harmful interference to radio communications. However, there is no guarantee that interference will not occur in a particular installation. If this equipment does cause harmful interference to radio or television reception, which can be determined by turning the equipment off and on, the user is encouraged to try to correct the interference by one or more of the following measures:

- Reorient or relocate the receiving antenna.
- Increase the separation between the equipment and receiver.
- Connect the equipment into an outlet on a circuit different from that to which the receiver is connected.
- Consult the dealer or an experienced radio/TV technician for help.

## Limited Warranty

True Innovations seating products are warranted against defects in material and workmanship while owned by the “Original Purchaser”. The term “Original Purchaser” is defined as that party or entity which purchases True Innovations furniture from an authorized True Innovations retailer as shown by the original sales receipt. This warranty does not apply to “as is” or previously owned seating products.

True Innovations warrants its products to be free from defects in materials and workmanship (normal wear and tear, fading and stretching excepted), for one year from the date of purchase, except as provided below under the limited warranty.

The exceptions or exclusions to this warranty are as follows:

1. Any warranty claim that is submitted after the limited warranty period, or without proper proof of purchase will not include the cost of parts, labor, or delivery.
2. This warranty shall not apply to the True Innovations products which have been subjected to misuse, neglect, alteration, modification, or attachments, either caused by the original purchaser, shipping, storage, accident, fire, flood, or acts of God.

In the event of a defect in material or workmanship covered by this warranty, True Innovations will repair or replace, at their discretion, without charge the warranted furniture within a reasonable amount of time. We reserve the right to require damaged parts to be returned to us upon request. Natural markings such as scars, brands, grain variations, wrinkles, color variations, etc., will be considered normal characteristics and not construed as defects. We cannot warrant leather against scratching or scuffing, as all leather is subject to blemishes with use.

For claims or questions concerning this warranty, please contact True Innovations Customer Service department on the web at [www.trueinnovations.com](http://www.trueinnovations.com). Be prepared to provide your name, address, daytime phone number, the model and purchase order number of the product, date of purchase, and the store where it was purchased. True Innovations requires that the original sales receipt be submitted with all requests to confirm that you are the original purchaser according to our written warranty.

All warranties are limited to the original purchaser for normal use by a person weighing less than 158.8 kg / 350lb.

AUSTRALIA: Our goods come with guarantees that cannot be excluded under the Australian Consumer Law. You are entitled to a replacement or refund for a major failure and for compensation for any other reasonably foreseeable loss or damage. You are also entitled to have the goods repaired or replaced if the goods fail to be of acceptable quality and the failure does not amount to a major failure.

### FCC Marking:

This device complies with Part 15 of the FCC Rules. Operation is subject to the following two conditions:

(1) this device may not cause harmful interference, and (2) this device must accept any interference received, including interference that may cause undesired operation.

### FCC Instruction:

Caution: Change or modifications not approved by the party responsible for compliance could void user's authority to operate the equipment.

NOTE: This equipment has been tested and found to comply with the limits for a Class B digital device, pursuant to Part 15 of the FCC Rules. These limits are designed to provide reasonable protection against harmful interference in a residential installation.

This equipment generates, uses and can radiate radio frequency energy and, if not installed and used in accordance with the instructions, may cause harmful interference to radio communications. However, there is no guarantee that interference will not occur in a particular installation. If this equipment does cause harmful interference to radio or television reception, which can be determined by turning the equipment off and on, the user is encouraged to try to correct the interference by one or more of the following measures:

- Reorient or relocate the receiving antenna.
- Increase the separation between the equipment and receiver.
- Connect the equipment into an outlet on a circuit different from that to which the receiver is connected.
- Consult the dealer or an experienced radio/TV technician for help.